

UBICACION DEL PROYECTO
ESCALA - 12/50000

PLANO DE UBICACION
ACTIVIDAD: MANTENIMIENTO DE PREVENCIÓN
POR EMERGENCIA DE LA RUTA DEPARTAMENTAL
TU-105- TRAMO: CAÑAVERAL - LA CHOZA

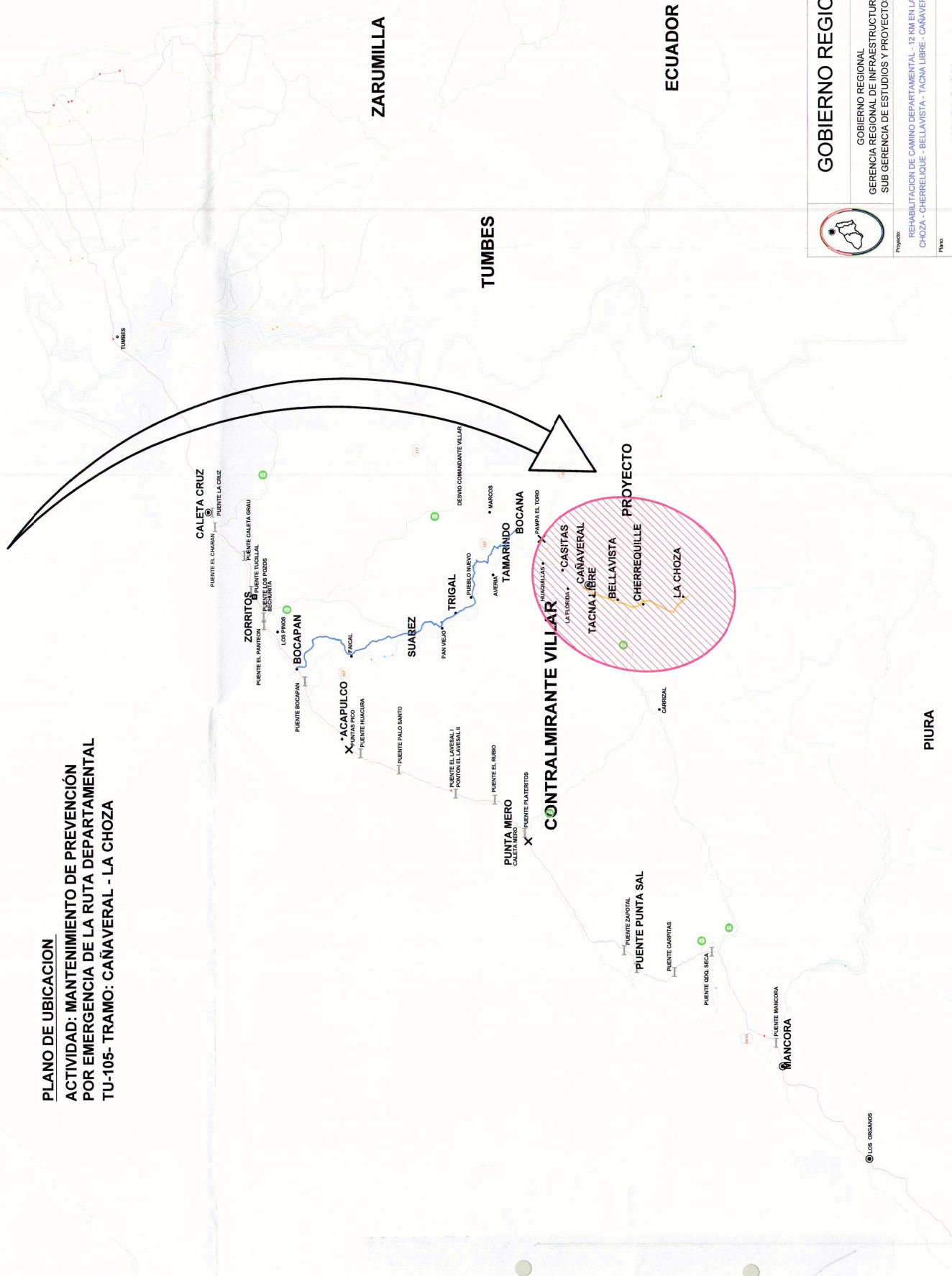

GOBIERNO REGIONAL TUMBES
SUBGERENCIA DE ESTUDIOS
FOLIO N° 023



	GOBIERNO REGIONAL DE TUMBES	
	Presidencia Regional: ING. WILMER DIOS BENITES Gerencia General: DOC. HAROLD BURGOS HERRERA Gerencia de Infraestructura: ING. WILMER CORDOVA LOPEZ Gerencia de Mantenimiento: ING. FREDDY R. SALAZAR CHONATE	Proyecto: REHABILITACION DE CAMINO DEPARTAMENTAL - 12 KM EN LA CHOZA - CHERREQUILLE - BELLAVISTA - TACNA LIBRE - CAÑAVERAL
	Fecha: ABRIL - 2019	Fecha: ABRIL - 2019
	Escala: INDICADA	Escala: INDICADA
	Ubicación: DISTRITO CASITAS	Ubicación: TUMBES CONT. VILLAR
		Hoja: CASITAS

UBICACION
DISTRITO CASITAS
TUMBES CONT. VILLAR

U-01

9 556 500 N

9 557 000 N

9 557 500 N

9 558 000 N

9 556 500 N

9 557 000 N

9 557 500 N

9 558 000 N

BADEN 09
EXISTENTE

5+300

5+400

5+500

5+600

5+700

5+800

5+900

6+000

6+100

6+200

6+300

6+400

6+500

6+600

6+700

6+800

6+900

7+000

7+100

7+200

7+300

7+400

7+500

7+600

7+700

7+800

7+900

8+000

8+100

8+200

8+300

8+400

8+500

8+600

8+700

8+800

8+900

9+000

9+100

9+200

9+300

9+400

9+500

9+600

9+700

9+800

9+900

10+000

10+100

10+200

10+300

10+400

10+500

10+600

10+700

10+800

10+900

11+000

11+100

11+200

11+300

11+400

11+500

11+600

11+700

11+800

11+900

12+000

12+100

12+200

12+300

12+400

12+500

12+600

12+700

12+800

12+900

13+000

13+100

13+200

13+300

13+400

13+500

13+600

13+700

13+800

13+900

14+000

PLATAFORMA
DEPORTIVA

QUEBRADA
CASITAS

BORDO
QUEBRADA

QUEBRADA
CASITAS

CASITA
DE
FUERZA

REGION TRANSVERSAL TIPICA

5.00

ANCHO DE CALZADA 12.00 m

SEÑALIZACION

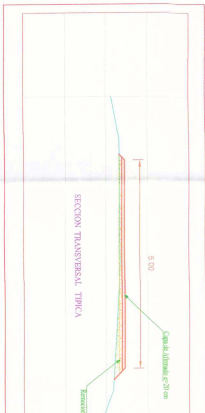

N 005 659 500 N

9 559 500 N

N 000 095 000 N

9 560 000 N

9 560 500 N

9 560 500 N

9 561 000 N

9 561 000 N

CANAL
ALCANTARILLA

BADEN 08
EXISTENTE

BADEN 07
EXISTENTE

BADEN 06
EXISTENTE

BADEN
EXISTENTE

BADEN
EXISTENTE

BADEN
02
EXISTENTE

FIN
PAVIMENTO

BELAVISTA
PAVIMENTO

INICIO
PAVIMENTO
BELAVISTA

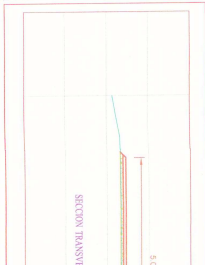

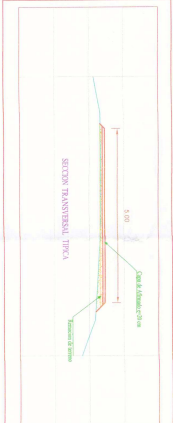
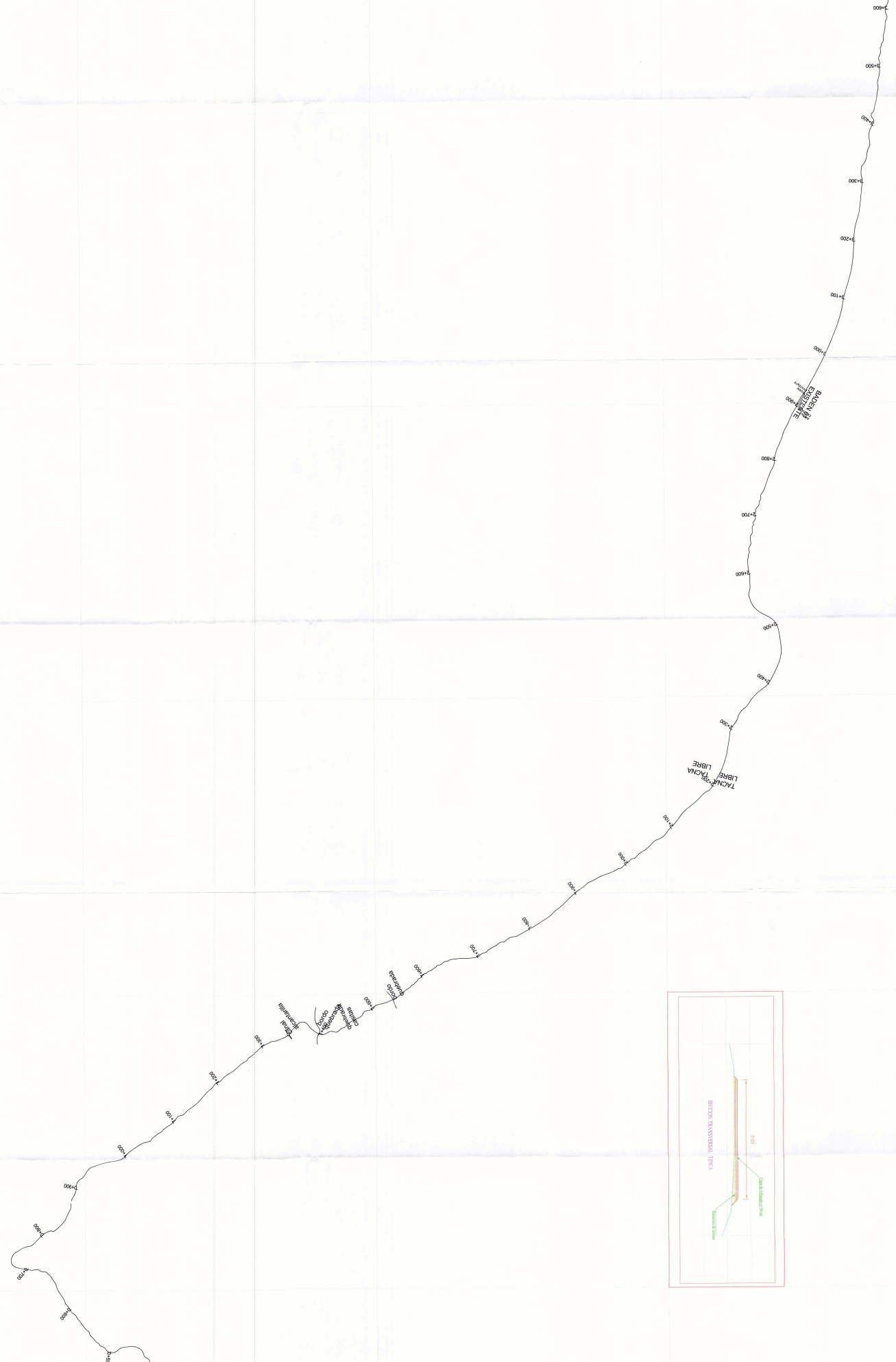

GO

 GERARDO

 SANCHEZ

 INGENIERO EN INGENIERIA CIVIL

 PLANVA

 INGENIERIA

CANAVERAL

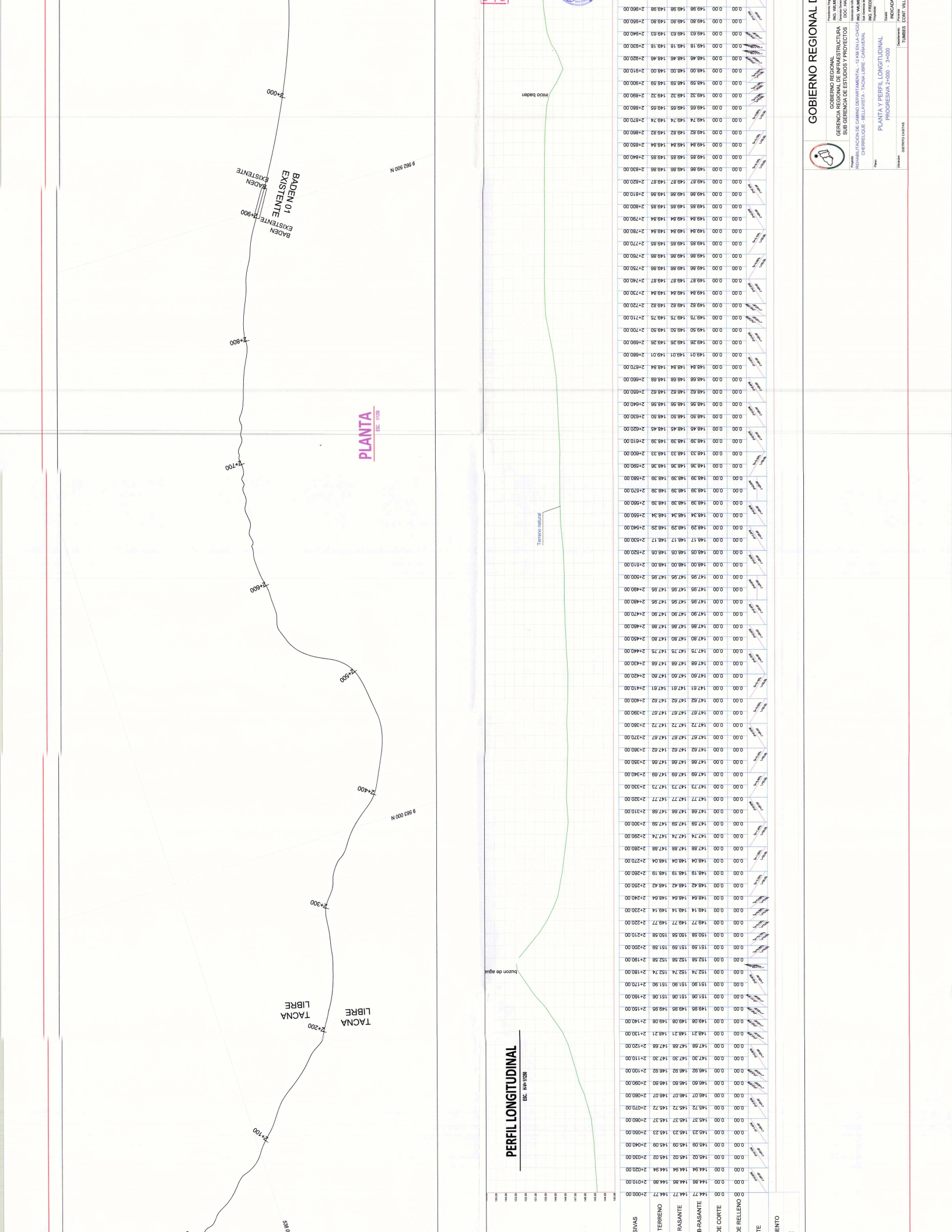

TIPO DE TERRENO	CANTIDAD	VALOR UNITARIO	TOTAL
SIVAS	0.00		0.00
TERRENO	2100.00	144.77	2100.00
DE RELENO	0.00		0.00
DE CORTE	0.00		0.00
RASANTE	145.72	145.37	21050.00
DE PASANTE	0.00		0.00
TERRENO	145.23	145.23	21050.00
DE RELENO	0.00		0.00
DE CORTE	0.00		0.00
RASANTE	145.72	145.72	21070.00
TERRENO	146.07	146.07	21080.00
DE RELENO	0.00		0.00
DE CORTE	0.00		0.00
RASANTE	146.52	146.52	21100.00
TERRENO	147.30	147.30	21110.00
DE RELENO	0.00		0.00
DE CORTE	0.00		0.00
RASANTE	147.68	147.68	21120.00
TERRENO	148.21	148.21	21130.00
DE RELENO	0.00		0.00
DE CORTE	0.00		0.00
RASANTE	148.08	148.08	21140.00
TERRENO	149.05	149.05	21150.00
DE RELENO	0.00		0.00
DE CORTE	0.00		0.00
RASANTE	150.08	150.08	21160.00
TERRENO	150.58	150.58	21170.00
DE RELENO	0.00		0.00
DE CORTE	0.00		0.00
RASANTE	150.58	150.58	21180.00
TERRENO	152.74	152.74	21190.00
DE RELENO	0.00		0.00
DE CORTE	0.00		0.00
RASANTE	152.58	152.58	21200.00
TERRENO	152.74	152.74	21210.00
DE RELENO	0.00		0.00
DE CORTE	0.00		0.00
RASANTE	152.58	152.58	21220.00
TERRENO	153.14	153.14	21230.00
DE RELENO	0.00		0.00
DE CORTE	0.00		0.00
RASANTE	153.14	153.14	21240.00
TERRENO	154.42	154.42	21250.00
DE RELENO	0.00		0.00
DE CORTE	0.00		0.00
RASANTE	154.42	154.42	21260.00
TERRENO	154.84	154.84	21270.00
DE RELENO	0.00		0.00
DE CORTE	0.00		0.00
RASANTE	154.84	154.84	21280.00
TERRENO	154.74	154.74	21290.00
DE RELENO	0.00		0.00
DE CORTE	0.00		0.00
RASANTE	154.74	154.74	21300.00
TERRENO	154.73	154.73	21310.00
DE RELENO	0.00		0.00
DE CORTE	0.00		0.00
RASANTE	154.73	154.73	21320.00
TERRENO	154.73	154.73	21330.00
DE RELENO	0.00		0.00
DE CORTE	0.00		0.00
RASANTE	154.73	154.73	21340.00
TERRENO	154.72	154.72	21350.00
DE RELENO	0.00		0.00
DE CORTE	0.00		0.00
RASANTE	154.72	154.72	21360.00
TERRENO	154.72	154.72	21370.00
DE RELENO	0.00		0.00
DE CORTE	0.00		0.00
RASANTE	154.72	154.72	21380.00
TERRENO	154.71	154.71	21390.00
DE RELENO	0.00		0.00
DE CORTE	0.00		0.00
RASANTE	154.71	154.71	21400.00
TERRENO	154.70	154.70	21410.00
DE RELENO	0.00		0.00
DE CORTE	0.00		0.00
RASANTE	154.70	154.70	21420.00
TERRENO	154.68	154.68	21430.00
DE RELENO	0.00		0.00
DE CORTE	0.00		0.00
RASANTE	154.68	154.68	21440.00
TERRENO	154.75	154.75	21450.00
DE RELENO	0.00		0.00
DE CORTE	0.00		0.00
RASANTE	154.75	154.75	21460.00
TERRENO	154.80	154.80	21470.00
DE RELENO	0.00		0.00
DE CORTE	0.00		0.00
RASANTE	154.80	154.80	21480.00
TERRENO	154.85	154.85	21490.00
DE RELENO	0.00		0.00
DE CORTE	0.00		0.00
RASANTE	154.85	154.85	21500.00
TERRENO	154.90	154.90	21510.00
DE RELENO	0.00		0.00
DE CORTE	0.00		0.00
RASANTE	154.90	154.90	21520.00
TERRENO	154.95	154.95	21530.00
DE RELENO	0.00		0.00
DE CORTE	0.00		0.00
RASANTE	154.95	154.95	21540.00
TERRENO	154.99	154.99	21550.00
DE RELENO	0.00		0.00
DE CORTE	0.00		0.00
RASANTE	154.99	154.99	21560.00
TERRENO	155.00	155.00	21570.00
DE RELENO	0.00		0.00
DE CORTE	0.00		0.00
RASANTE	155.00	155.00	21580.00
TERRENO	155.00	155.00	21590.00
DE RELENO	0.00		0.00
DE CORTE	0.00		0.00
RASANTE	155.00	155.00	21600.00
TERRENO	155.00	155.00	21610.00
DE RELENO	0.00		0.00
DE CORTE	0.00		0.00
RASANTE	155.00	155.00	21620.00
TERRENO	155.00	155.00	21630.00
DE RELENO	0.00		0.00
DE CORTE	0.00		0.00
RASANTE	155.00	155.00	21640.00
TERRENO	155.00	155.00	21650.00
DE RELENO	0.00		0.00
DE CORTE	0.00		0.00
RASANTE	155.00	155.00	21660.00
TERRENO	155.00	155.00	21670.00
DE RELENO	0.00		0.00
DE CORTE	0.00		0.00
RASANTE	155.00	155.00	21680.00
TERRENO	155.00	155.00	21690.00
DE RELENO	0.00		0.00
DE CORTE	0.00		0.00
RASANTE	155.00	155.00	21700.00
TERRENO	155.00	155.00	21710.00
DE RELENO	0.00		0.00
DE CORTE	0.00		0.00
RASANTE	155.00	155.00	21720.00
TERRENO	155.00	155.00	21730.00
DE RELENO	0.00		0.00
DE CORTE	0.00		0.00
RASANTE	155.00	155.00	21740.00
TERRENO	155.00	155.00	21750.00
DE RELENO	0.00		0.00
DE CORTE	0.00		0.00
RASANTE	155.00	155.00	21760.00
TERRENO	155.00	155.00	21770.00
DE RELENO	0.00		0.00
DE CORTE	0.00		0.00
RASANTE	155.00	155.00	21780.00
TERRENO	155.00	155.00	21790.00
DE RELENO	0.00		0.00
DE CORTE	0.00		0.00
RASANTE	155.00	155.00	21800.00
TERRENO	155.00	155.00	21810.00
DE RELENO	0.00		0.00
DE CORTE	0.00		0.00
RASANTE	155.00	155.00	21820.00
TERRENO	155.00	155.00	21830.00
DE RELENO	0.00		0.00
DE CORTE	0.00		0.00
RASANTE	155.00	155.00	21840.00
TERRENO	155.00	155.00	21850.00
DE RELENO	0.00		0.00
DE CORTE	0.00		0.00
RASANTE	155.00	155.00	21860.00
TERRENO	155.00	155.00	21870.00
DE RELENO	0.00		0.00
DE CORTE	0.00		0.00
RASANTE	155.00	155.00	21880.00
TERRENO	155.00	155.00	21890.00
DE RELENO	0.00		0.00
DE CORTE	0.00		0.00
RASANTE	155.00	155.00	21900.00
TERRENO	155.00	155.00	21910.00
DE RELENO	0.00		0.00
DE CORTE	0.00		0.00
RASANTE	155.00	155.00	21920.00
TERRENO	155.00	155.00	21930.00
DE RELENO	0.00		0.00
DE CORTE	0.00		0.00
RASANTE	155.00	155.00	21940.00
TERRENO	155.00	155.00	21950.00
DE RELENO	0.00		0.00
DE CORTE	0.00		0.00
RASANTE	155.00	155.00	21960.00
TERRENO	155.00	155.00	21970.00
DE RELENO	0.00		0.00
DE CORTE	0.00		0.00
RASANTE	155.00	155.00	21980.00
TERRENO	155.00	155.00	21990.00
DE RELENO	0.00		0.00
DE CORTE	0.00		0.00
RASANTE	155.00	155.00	22000.00

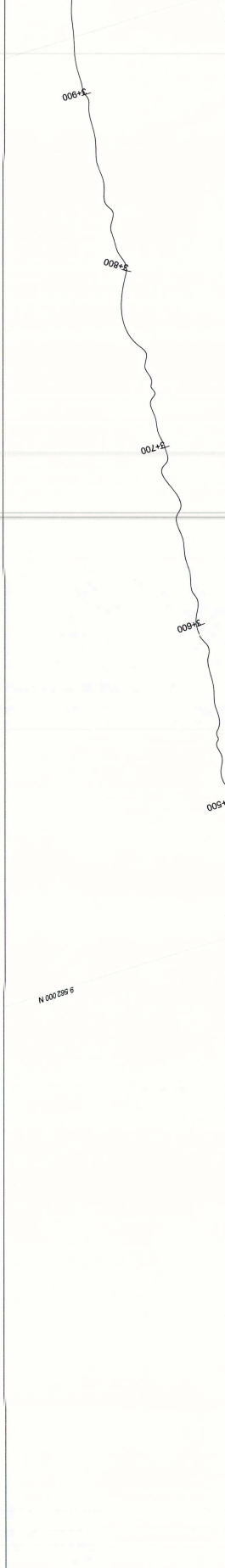

PLANTA
ESC. 1:1000

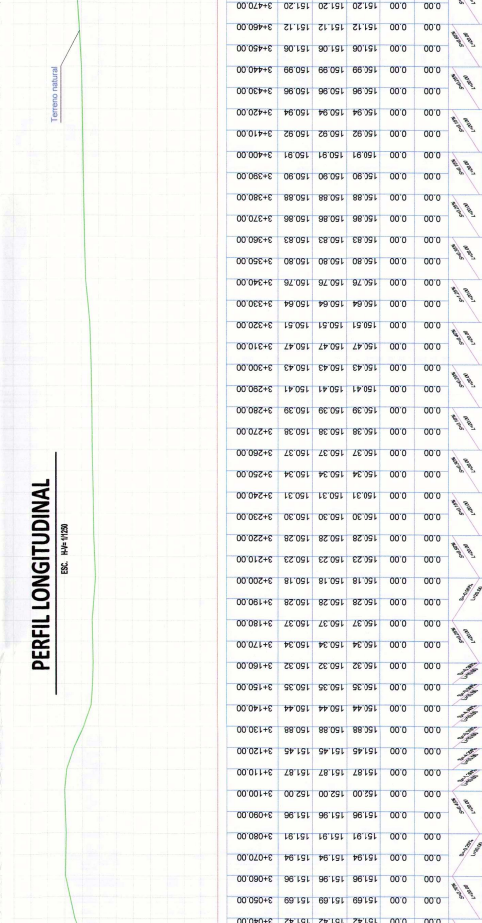

PERFIL LONGITUDINAL
ESC. 1:1000

Estación	Perfil Longitudinal	Perfil Transversal	Perfil Longitudinal	Perfil Transversal
149.97	150.24	150.24	150.24	150.24
150.00	150.25	150.25	150.25	150.25
150.03	150.26	150.26	150.26	150.26
150.06	150.27	150.27	150.27	150.27
150.09	150.28	150.28	150.28	150.28
150.12	150.29	150.29	150.29	150.29
150.15	150.30	150.30	150.30	150.30
150.18	150.31	150.31	150.31	150.31
150.21	150.32	150.32	150.32	150.32
150.24	150.33	150.33	150.33	150.33
150.27	150.34	150.34	150.34	150.34
150.30	150.35	150.35	150.35	150.35
150.33	150.36	150.36	150.36	150.36
150.36	150.37	150.37	150.37	150.37
150.39	150.38	150.38	150.38	150.38
150.42	150.39	150.39	150.39	150.39
150.45	150.40	150.40	150.40	150.40
150.48	150.41	150.41	150.41	150.41
150.51	150.42	150.42	150.42	150.42
150.54	150.43	150.43	150.43	150.43
150.57	150.44	150.44	150.44	150.44
150.60	150.45	150.45	150.45	150.45
150.63	150.46	150.46	150.46	150.46
150.66	150.47	150.47	150.47	150.47
150.69	150.48	150.48	150.48	150.48
150.72	150.49	150.49	150.49	150.49
150.75	150.50	150.50	150.50	150.50
150.78	150.51	150.51	150.51	150.51
150.81	150.52	150.52	150.52	150.52
150.84	150.53	150.53	150.53	150.53
150.87	150.54	150.54	150.54	150.54
150.90	150.55	150.55	150.55	150.55
150.93	150.56	150.56	150.56	150.56
150.96	150.57	150.57	150.57	150.57
150.99	150.58	150.58	150.58	150.58
151.02	150.59	150.59	150.59	150.59
151.05	150.60	150.60	150.60	150.60
151.08	150.61	150.61	150.61	150.61
151.11	150.62	150.62	150.62	150.62
151.14	150.63	150.63	150.63	150.63
151.17	150.64	150.64	150.64	150.64
151.20	150.65	150.65	150.65	150.65
151.23	150.66	150.66	150.66	150.66
151.26	150.67	150.67	150.67	150.67
151.29	150.68	150.68	150.68	150.68
151.32	150.69	150.69	150.69	150.69
151.35	150.70	150.70	150.70	150.70
151.38	150.71	150.71	150.71	150.71
151.41	150.72	150.72	150.72	150.72
151.44	150.73	150.73	150.73	150.73
151.47	150.74	150.74	150.74	150.74
151.50	150.75	150.75	150.75	150.75
151.53	150.76	150.76	150.76	150.76
151.56	150.77	150.77	150.77	150.77
151.59	150.78	150.78	150.78	150.78
151.62	150.79	150.79	150.79	150.79
151.65	150.80	150.80	150.80	150.80
151.68	150.81	150.81	150.81	150.81
151.71	150.82	150.82	150.82	150.82
151.74	150.83	150.83	150.83	150.83
151.77	150.84	150.84	150.84	150.84
151.80	150.85	150.85	150.85	150.85
151.83	150.86	150.86	150.86	150.86
151.86	150.87	150.87	150.87	150.87
151.89	150.88	150.88	150.88	150.88
151.92	150.89	150.89	150.89	150.89
151.95	150.90	150.90	150.90	150.90
151.98	150.91	150.91	150.91	150.91
152.01	150.92	150.92	150.92	150.92
152.04	150.93	150.93	150.93	150.93
152.07	150.94	150.94	150.94	150.94
152.10	150.95	150.95	150.95	150.95
152.13	150.96	150.96	150.96	150.96
152.16	150.97	150.97	150.97	150.97
152.19	150.98	150.98	150.98	150.98
152.22	150.99	150.99	150.99	150.99
152.25	151.00	151.00	151.00	151.00
152.28	151.01	151.01	151.01	151.01
152.31	151.02	151.02	151.02	151.02
152.34	151.03	151.03	151.03	151.03
152.37	151.04	151.04	151.04	151.04
152.40	151.05	151.05	151.05	151.05
152.43	151.06	151.06	151.06	151.06
152.46	151.07	151.07	151.07	151.07
152.49	151.08	151.08	151.08	151.08
152.52	151.09	151.09	151.09	151.09
152.55	151.10	151.10	151.10	151.10
152.58	151.11	151.11	151.11	151.11
152.61	151.12	151.12	151.12	151.12
152.64	151.13	151.13	151.13	151.13
152.67	151.14	151.14	151.14	151.14
152.70	151.15	151.15	151.15	151.15
152.73	151.16	151.16	151.16	151.16
152.76	151.17	151.17	151.17	151.17
152.79	151.18	151.18	151.18	151.18
152.82	151.19	151.19	151.19	151.19
152.85	151.20	151.20	151.20	151.20
152.88	151.21	151.21	151.21	151.21
152.91	151.22	151.22	151.22	151.22
152.94	151.23	151.23	151.23	151.23
152.97	151.24	151.24	151.24	151.24
153.00	151.25	151.25	151.25	151.25



GOBIERNO REGIONAL
GOBIERNO REGIONAL DEL CAUCA
GERENCIA DE INFRAESTRUCTURA
SUB GERENCIA DE ESTUDIOS Y PROYECTOS

Proyecto: RECONSTRUCCION DEL CAMINO DEPARTAMENTAL 43 EN LA LOCALIDAD DE...
Municipio: CHERRELOE, BELLA VISTA, TACNA LIBRE, CAJAMARCA

Plan: PLANTA Y PERFIL LONGITUDINAL
PROGRESIVA 3+000 - 4+000

Escala: INDICADA
Elaborado: ...
Revisado: ...
Aprobado: ...

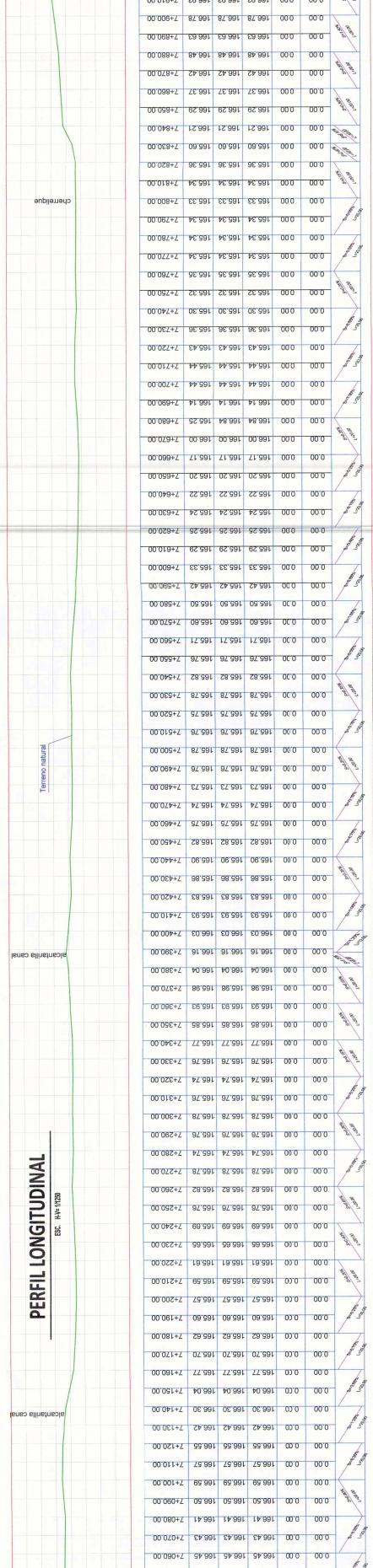

NO	TE	NT	TE	LENO
7+000	154.81	154.81	154.81	7+000.00
7+010	155.32	155.32	155.32	7+010.00
7+020	155.82	155.82	155.82	7+020.00
7+030	156.18	156.18	156.18	7+030.00
7+040	156.47	156.47	156.47	7+040.00
7+050	156.46	156.46	156.46	7+050.00
7+060	156.45	156.45	156.45	7+060.00
7+070	156.43	156.43	156.43	7+070.00
7+080	156.41	156.41	156.41	7+080.00
7+090	156.50	156.50	156.50	7+090.00
7+100	156.59	156.59	156.59	7+100.00
7+110	156.57	156.57	156.57	7+110.00
7+120	156.55	156.55	156.55	7+120.00
7+130	156.42	156.42	156.42	7+130.00
7+140	156.30	156.30	156.30	7+140.00
7+150	156.04	156.04	156.04	7+150.00
7+160	155.77	155.77	155.77	7+160.00
7+170	155.70	155.70	155.70	7+170.00
7+180	155.60	155.60	155.60	7+180.00
7+190	155.60	155.60	155.60	7+190.00
7+200	155.57	155.57	155.57	7+200.00
7+210	155.59	155.59	155.59	7+210.00
7+220	155.61	155.61	155.61	7+220.00
7+230	155.65	155.65	155.65	7+230.00
7+240	155.69	155.69	155.69	7+240.00
7+250	155.75	155.75	155.75	7+250.00
7+260	155.82	155.82	155.82	7+260.00
7+270	155.78	155.78	155.78	7+270.00
7+280	155.74	155.74	155.74	7+280.00
7+290	155.75	155.75	155.75	7+290.00
7+300	155.78	155.78	155.78	7+300.00
7+310	155.75	155.75	155.75	7+310.00
7+320	155.74	155.74	155.74	7+320.00
7+330	155.77	155.77	155.77	7+330.00
7+340	155.85	155.85	155.85	7+340.00
7+350	155.93	155.93	155.93	7+350.00
7+360	155.98	155.98	155.98	7+360.00
7+370	156.04	156.04	156.04	7+370.00
7+380	156.16	156.16	156.16	7+380.00
7+390	156.03	156.03	156.03	7+390.00
7+400	155.93	155.93	155.93	7+400.00
7+410	155.83	155.83	155.83	7+410.00
7+420	155.80	155.80	155.80	7+420.00
7+430	155.90	155.90	155.90	7+430.00
7+440	155.82	155.82	155.82	7+440.00
7+450	155.75	155.75	155.75	7+450.00
7+460	155.74	155.74	155.74	7+460.00
7+470	155.74	155.74	155.74	7+470.00
7+480	155.73	155.73	155.73	7+480.00
7+490	155.78	155.78	155.78	7+490.00
7+500	155.78	155.78	155.78	7+500.00
7+510	155.78	155.78	155.78	7+510.00
7+520	155.75	155.75	155.75	7+520.00
7+530	155.78	155.78	155.78	7+530.00
7+540	155.82	155.82	155.82	7+540.00
7+550	155.78	155.78	155.78	7+550.00
7+560	155.71	155.71	155.71	7+560.00
7+570	155.80	155.80	155.80	7+570.00
7+580	155.50	155.50	155.50	7+580.00
7+590	155.42	155.42	155.42	7+590.00
7+600	155.33	155.33	155.33	7+600.00
7+610	155.29	155.29	155.29	7+610.00
7+620	155.29	155.29	155.29	7+620.00
7+630	155.24	155.24	155.24	7+630.00
7+640	155.22	155.22	155.22	7+640.00
7+650	155.17	155.17	155.17	7+650.00
7+660	155.17	155.17	155.17	7+660.00
7+670	155.00	155.00	155.00	7+670.00
7+680	154.84	154.84	154.84	7+680.00
7+690	154.84	154.84	154.84	7+690.00
7+700	154.43	154.43	154.43	7+700.00
7+710	154.44	154.44	154.44	7+710.00
7+720	154.43	154.43	154.43	7+720.00
7+730	154.36	154.36	154.36	7+730.00
7+740	154.32	154.32	154.32	7+740.00
7+750	154.30	154.30	154.30	7+750.00
7+760	154.32	154.32	154.32	7+760.00
7+770	154.33	154.33	154.33	7+770.00
7+780	154.34	154.34	154.34	7+780.00
7+790	154.34	154.34	154.34	7+790.00
7+800	154.34	154.34	154.34	7+800.00
7+810	154.36	154.36	154.36	7+810.00
7+820	154.30	154.30	154.30	7+820.00
7+830	154.60	154.60	154.60	7+830.00
7+840	154.21	154.21	154.21	7+840.00
7+850	154.29	154.29	154.29	7+850.00
7+860	154.29	154.29	154.29	7+860.00
7+870	154.27	154.27	154.27	7+870.00
7+880	154.27	154.27	154.27	7+880.00
7+890	154.48	154.48	154.48	7+890.00
7+900	154.63	154.63	154.63	7+900.00
7+910	154.78	154.78	154.78	7+910.00
7+920	154.08	154.08	154.08	7+920.00
7+930	154.00	154.00	154.00	7+930.00
7+940	154.00	154.00	154.00	7+940.00
7+950	154.00	154.00	154.00	7+950.00
7+960	154.00	154.00	154.00	7+960.00
7+970	154.00	154.00	154.00	7+970.00
7+980	154.00	154.00	154.00	7+980.00
7+990	154.00	154.00	154.00	7+990.00
8+000	154.00	154.00	154.00	8+000.00

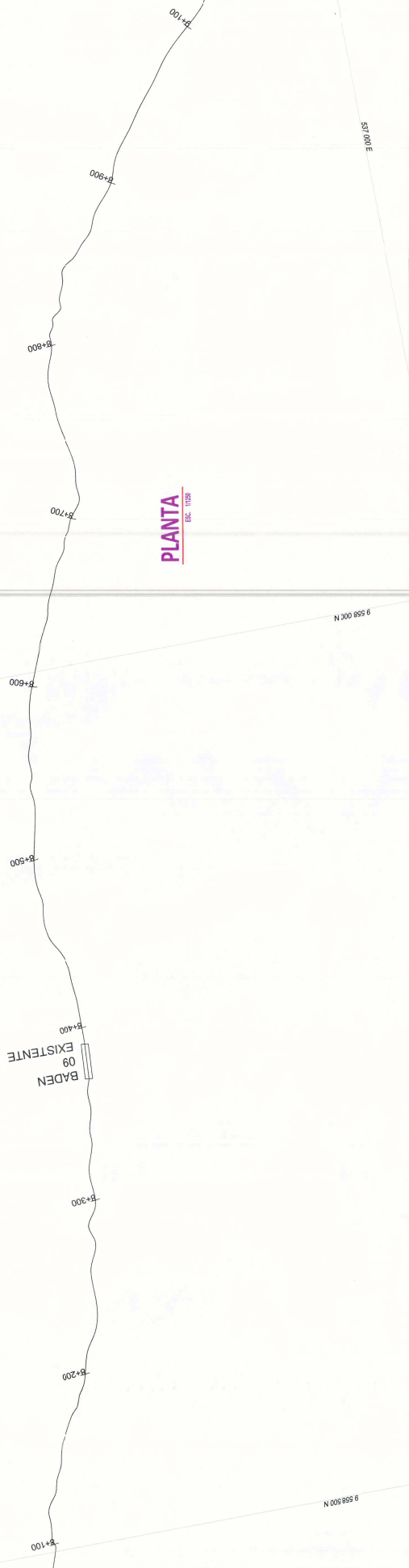

PLANTA
ESC. 1:200

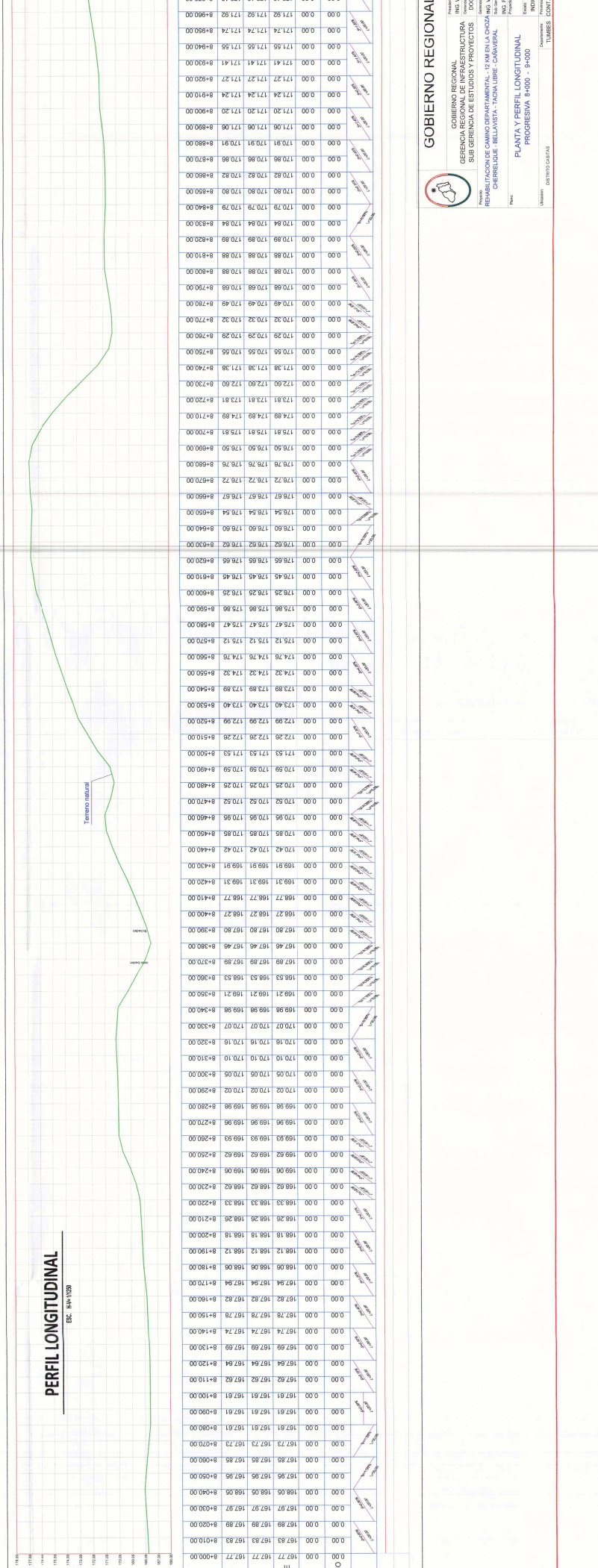

PERFIL LONGITUDINAL
ESC. 1/100

Estacion	Nivel	Altimetrico	Propuesta	Inclinacion	Altimetrico	Nivel
9+500	1571.92	1571.92			1571.92	1571.92
9+490	1574.74	1574.74			1574.74	1574.74
9+480	1571.65	1571.65			1571.65	1571.65
9+470	1571.41	1571.41			1571.41	1571.41
9+460	1571.27	1571.27			1571.27	1571.27
9+450	1571.24	1571.24			1571.24	1571.24
9+440	1571.20	1571.20			1571.20	1571.20
9+430	1571.06	1571.06			1571.06	1571.06
9+420	1570.91	1570.91			1570.91	1570.91
9+410	1570.86	1570.86			1570.86	1570.86
9+400	1570.82	1570.82			1570.82	1570.82
9+390	1570.80	1570.80			1570.80	1570.80
9+380	1570.79	1570.79			1570.79	1570.79
9+370	1570.84	1570.84			1570.84	1570.84
9+360	1570.89	1570.89			1570.89	1570.89
9+350	1570.88	1570.88			1570.88	1570.88
9+340	1570.88	1570.88			1570.88	1570.88
9+330	1570.88	1570.88			1570.88	1570.88
9+320	1570.88	1570.88			1570.88	1570.88
9+310	1570.88	1570.88			1570.88	1570.88
9+300	1570.88	1570.88			1570.88	1570.88
9+290	1570.88	1570.88			1570.88	1570.88
9+280	1570.88	1570.88			1570.88	1570.88
9+270	1570.88	1570.88			1570.88	1570.88
9+260	1570.88	1570.88			1570.88	1570.88
9+250	1570.88	1570.88			1570.88	1570.88
9+240	1570.88	1570.88			1570.88	1570.88
9+230	1570.88	1570.88			1570.88	1570.88
9+220	1570.88	1570.88			1570.88	1570.88
9+210	1570.88	1570.88			1570.88	1570.88
9+200	1570.88	1570.88			1570.88	1570.88
9+190	1570.88	1570.88			1570.88	1570.88
9+180	1570.88	1570.88			1570.88	1570.88
9+170	1570.88	1570.88			1570.88	1570.88
9+160	1570.88	1570.88			1570.88	1570.88
9+150	1570.88	1570.88			1570.88	1570.88
9+140	1570.88	1570.88			1570.88	1570.88
9+130	1570.88	1570.88			1570.88	1570.88
9+120	1570.88	1570.88			1570.88	1570.88
9+110	1570.88	1570.88			1570.88	1570.88
9+100	1570.88	1570.88			1570.88	1570.88
9+90	1570.88	1570.88			1570.88	1570.88
9+80	1570.88	1570.88			1570.88	1570.88
9+70	1570.88	1570.88			1570.88	1570.88
9+60	1570.88	1570.88			1570.88	1570.88
9+500	1571.92	1571.92			1571.92	1571.92

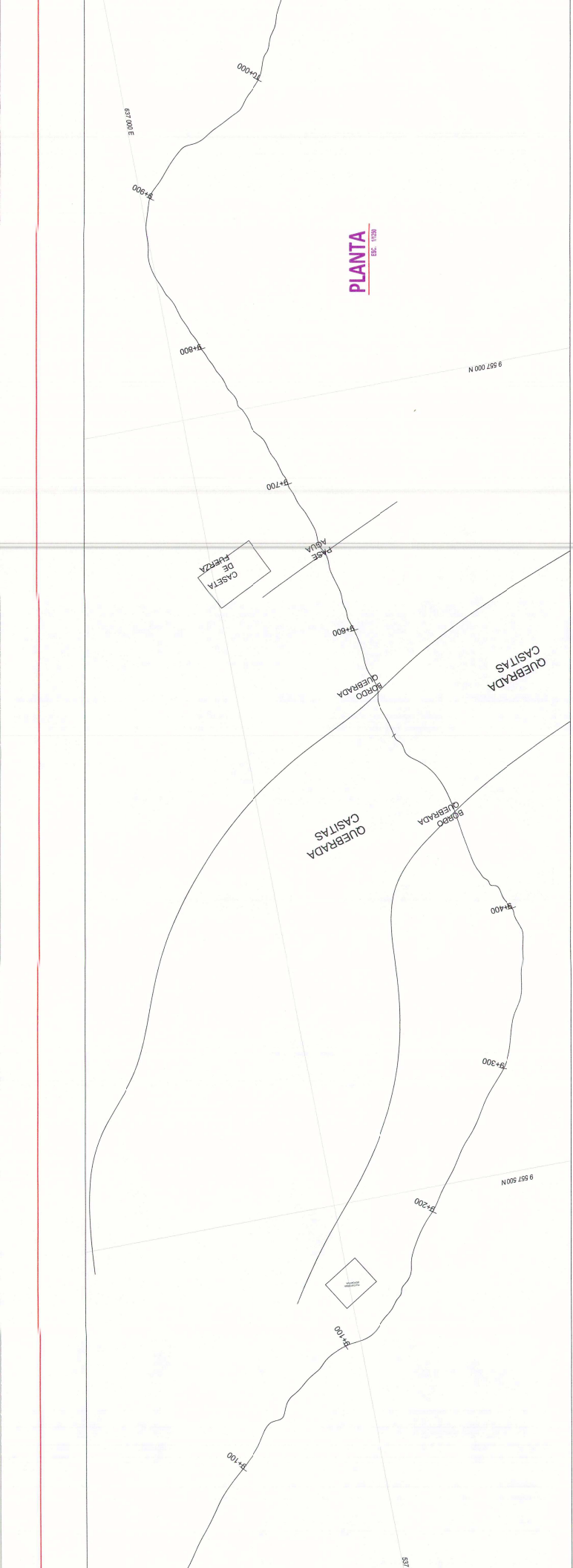

PLANTA
ESC. 1:200

PERFIL LONGITUDINAL
ESC. 1:40 (1:200)

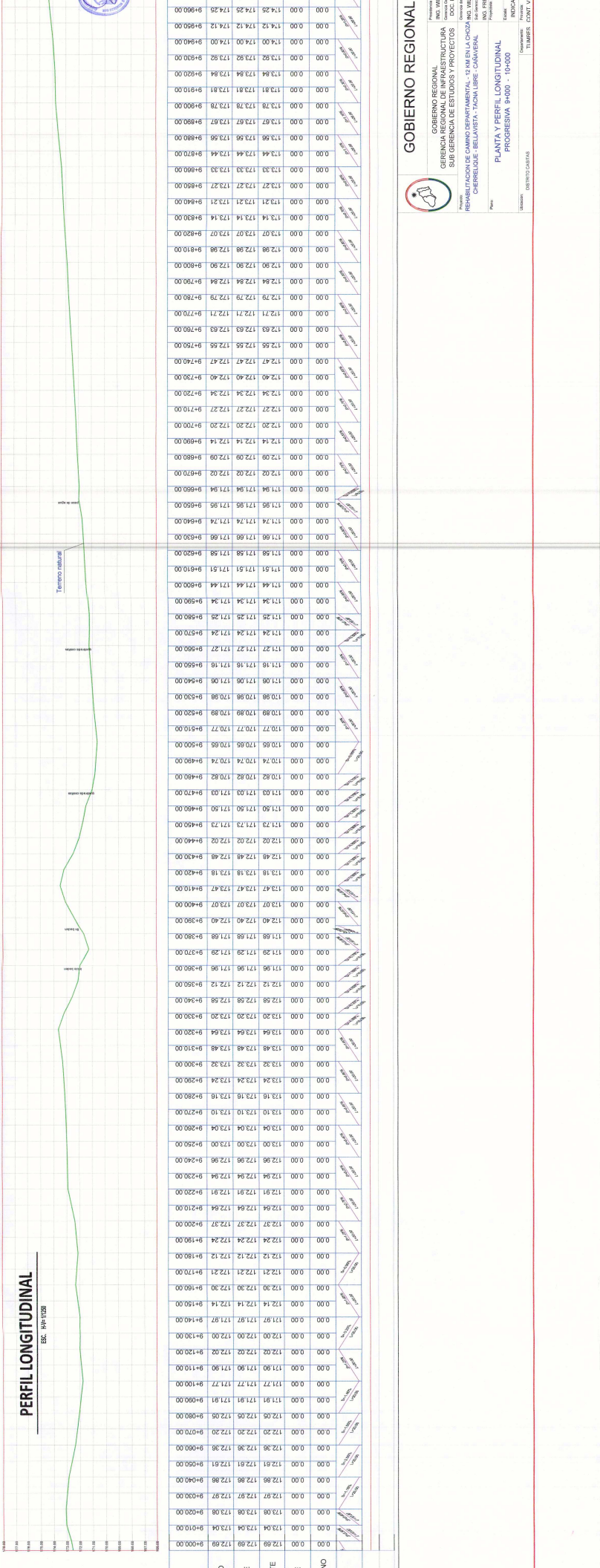

GOBIERNO REGIONAL

Gerencia Regional de Infraestructura y Proyectos
 Gerencia de Estudios y Proyectos

PROYECTO: RECONSTRUCCIÓN DE CAMINO DEPARTAMENTAL - 10 MENA COZA / CARRANZA / BELLANZA / TACNA LIBRE - CARRANZA / CARRANZA

PLANTA Y PERFIL LONGITUDINAL
PROGRESIVA 9+000 - 10+000

INDICACIONES: ELIMINAR Y COLOCAR

Stationing	Profile Elevation	Ground Elevation
9+000	172.89	173.04
9+010	172.89	173.04
9+020	172.89	173.04
9+030	172.89	173.04
9+040	172.89	173.04
9+050	172.89	173.04
9+060	172.89	173.04
9+070	172.89	173.04
9+080	172.89	173.04
9+090	172.89	173.04
9+100	172.89	173.04
9+110	172.89	173.04
9+120	172.89	173.04
9+130	172.89	173.04
9+140	172.89	173.04
9+150	172.89	173.04
9+160	172.89	173.04
9+170	172.89	173.04
9+180	172.89	173.04
9+190	172.89	173.04
9+200	172.89	173.04
9+210	172.89	173.04
9+220	172.89	173.04
9+230	172.89	173.04
9+240	172.89	173.04
9+250	172.89	173.04
9+260	172.89	173.04
9+270	172.89	173.04
9+280	172.89	173.04
9+290	172.89	173.04
9+300	172.89	173.04
9+310	172.89	173.04
9+320	172.89	173.04
9+330	172.89	173.04
9+340	172.89	173.04
9+350	172.89	173.04
9+360	172.89	173.04
9+370	172.89	173.04
9+380	172.89	173.04
9+390	172.89	173.04
9+400	172.89	173.04
9+410	172.89	173.04
9+420	172.89	173.04
9+430	172.89	173.04
9+440	172.89	173.04
9+450	172.89	173.04
9+460	172.89	173.04
9+470	172.89	173.04
9+480	172.89	173.04
9+490	172.89	173.04
9+500	172.89	173.04
9+510	172.89	173.04
9+520	172.89	173.04
9+530	172.89	173.04
9+540	172.89	173.04
9+550	172.89	173.04
9+560	172.89	173.04
9+570	172.89	173.04
9+580	172.89	173.04
9+590	172.89	173.04
9+600	172.89	173.04
9+610	172.89	173.04
9+620	172.89	173.04
9+630	172.89	173.04
9+640	172.89	173.04
9+650	172.89	173.04
9+660	172.89	173.04
9+670	172.89	173.04
9+680	172.89	173.04
9+690	172.89	173.04
9+700	172.89	173.04
9+710	172.89	173.04
9+720	172.89	173.04
9+730	172.89	173.04
9+740	172.89	173.04
9+750	172.89	173.04
9+760	172.89	173.04
9+770	172.89	173.04
9+780	172.89	173.04
9+790	172.89	173.04
9+800	172.89	173.04
9+810	172.89	173.04
9+820	172.89	173.04
9+830	172.89	173.04
9+840	172.89	173.04
9+850	172.89	173.04
9+860	172.89	173.04
9+870	172.89	173.04
9+880	172.89	173.04
9+890	172.89	173.04
9+900	172.89	173.04
9+910	172.89	173.04
9+920	172.89	173.04
9+930	172.89	173.04
9+940	172.89	173.04
9+950	172.89	173.04
9+960	172.89	173.04
9+970	172.89	173.04
9+980	172.89	173.04
9+990	172.89	173.04
10+000	172.89	173.04

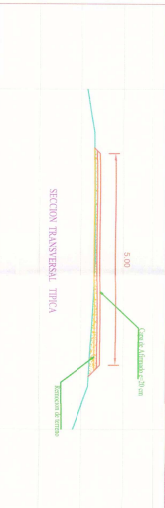
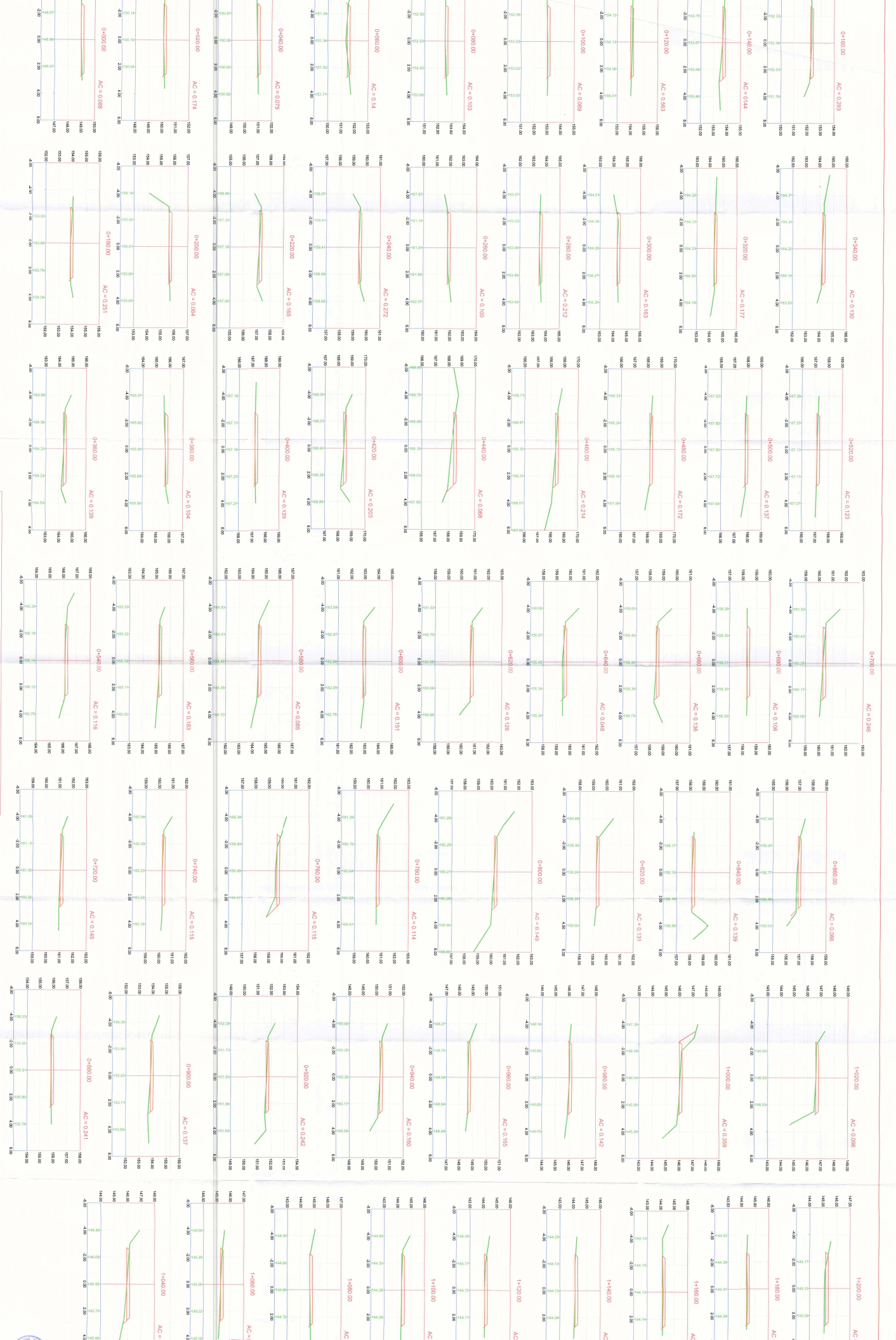

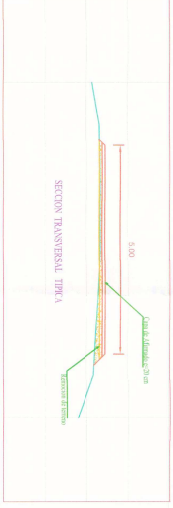
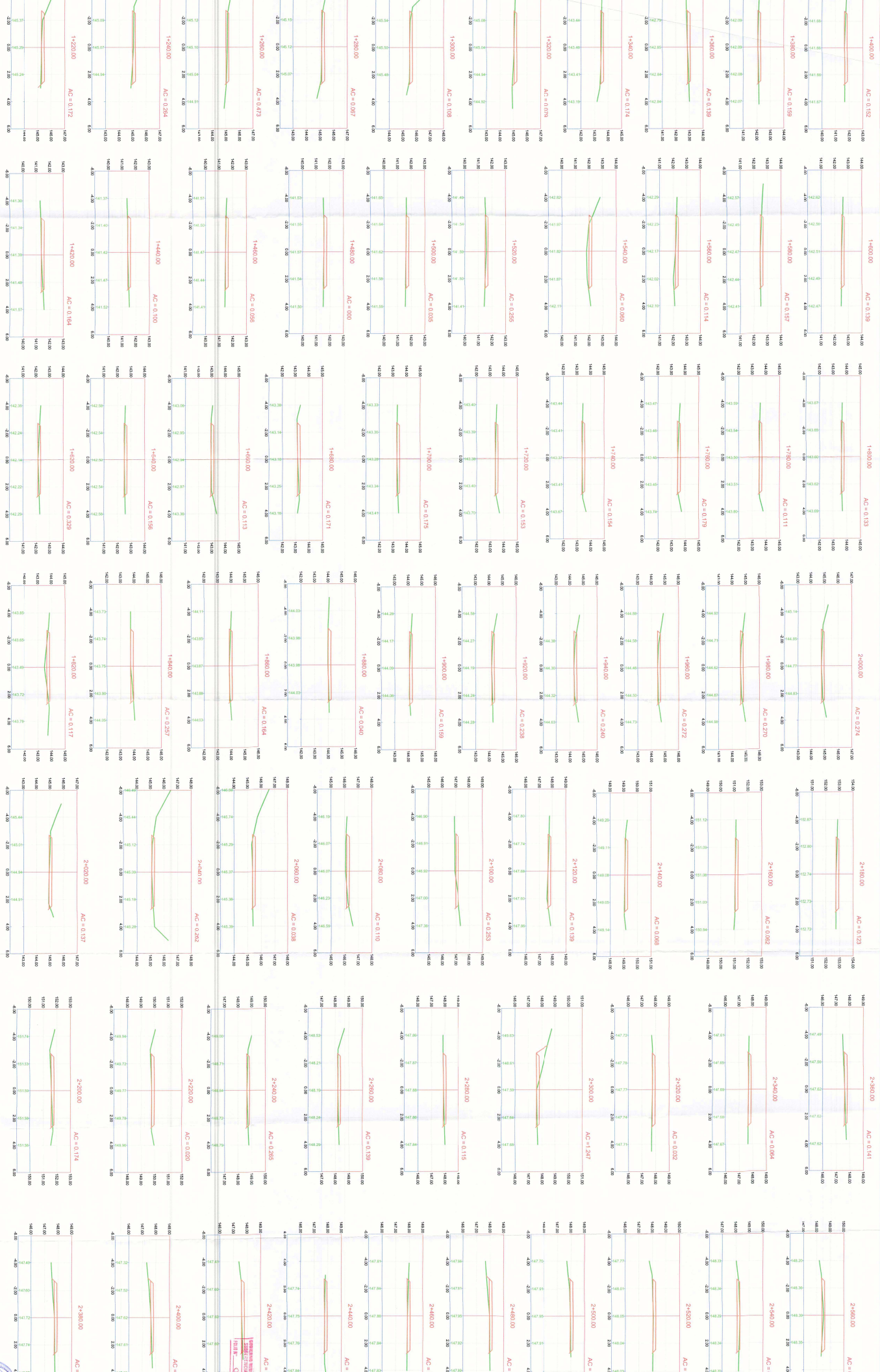

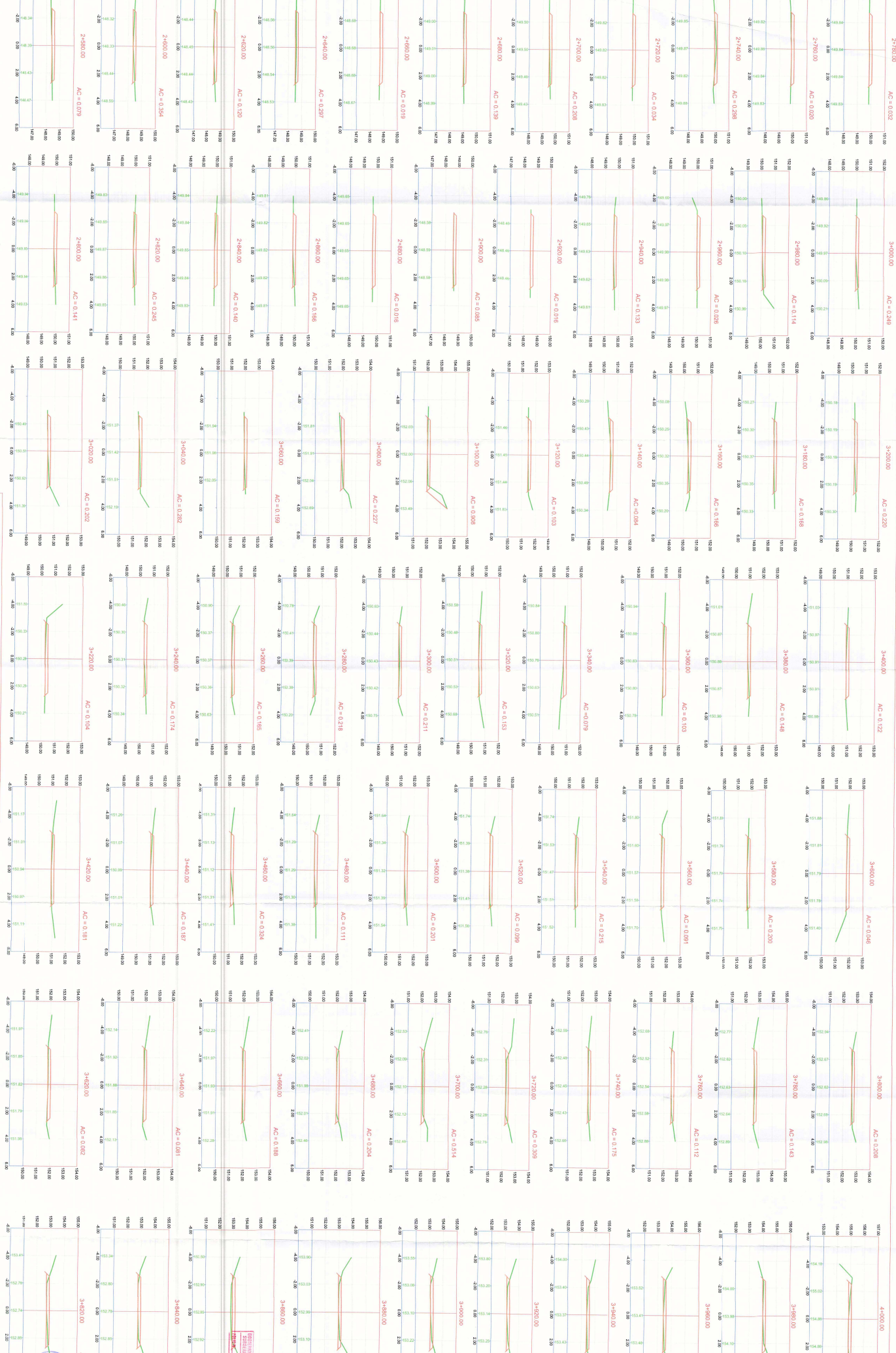

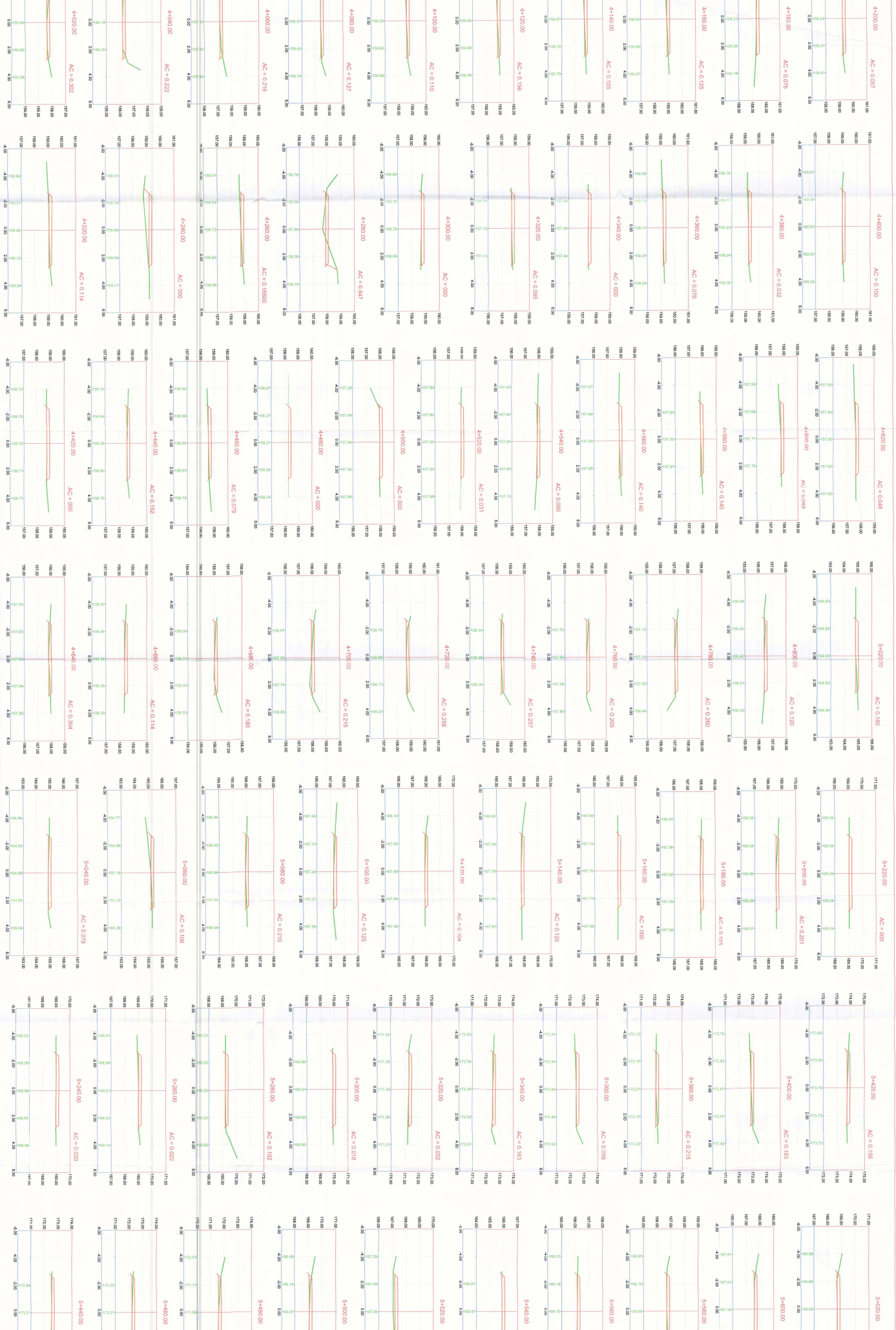

GOBIERNO REGIONAL
 REGIONAL GOVERNMENT
 DEPARTAMENTO DE INGENIERIA CIVIL
 CIVIL ENGINEERING DEPARTMENT
 DIVISION DE OBRAS DE CONSTRUCCION
 CONSTRUCTION WORKS DIVISION
 PROYECTO DE OBRAS DE CONSTRUCCION
 CONSTRUCTION WORKS PROJECT
 RECONSTRUCCION TRANSVERSAL
 CROSS RECONSTRUCTION
 PROCEDIMIENTO 4-000 5-400
 PROCEDURE 4-000 5-400

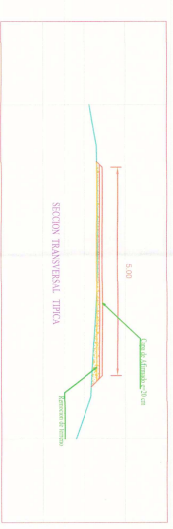
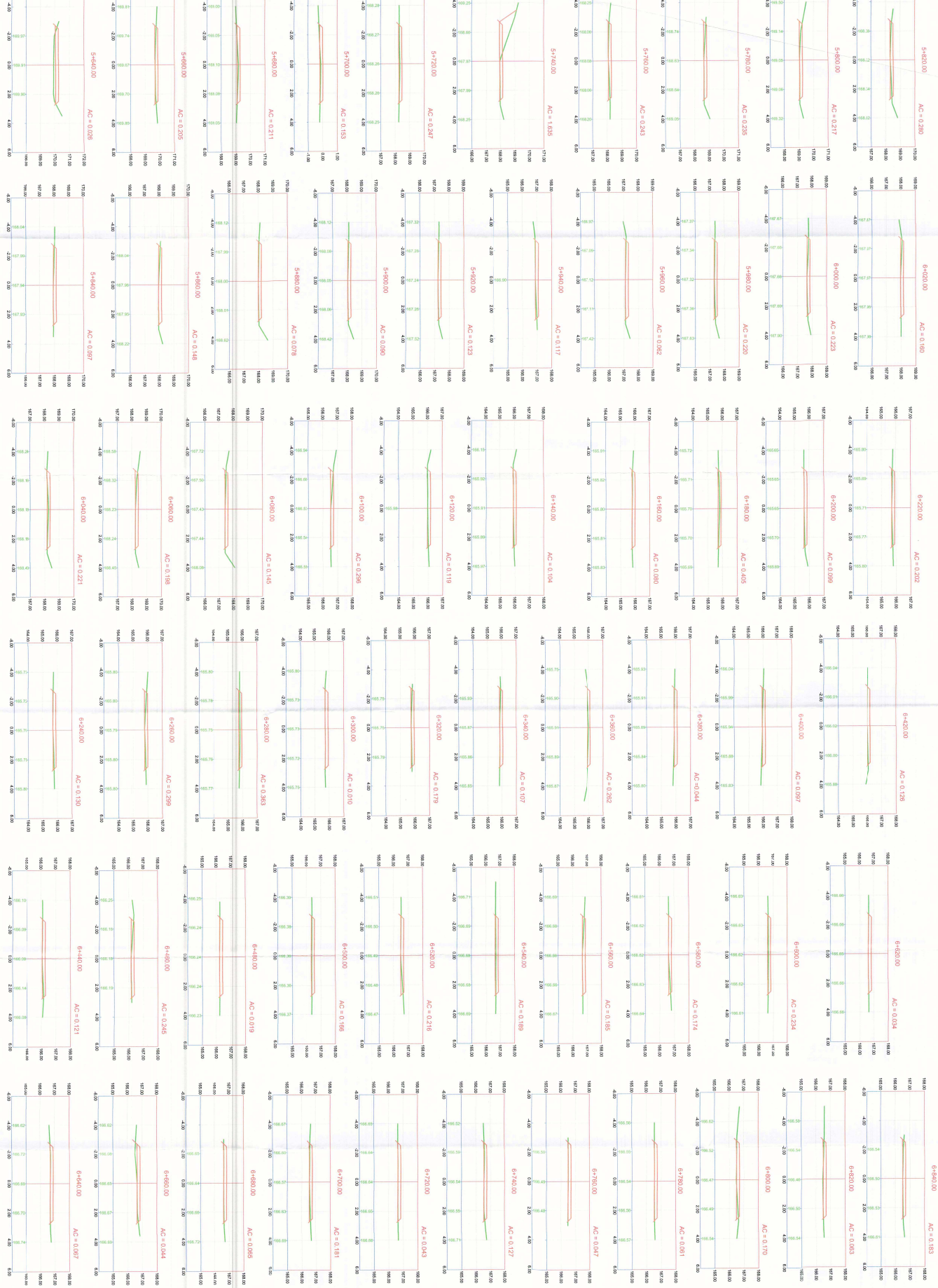

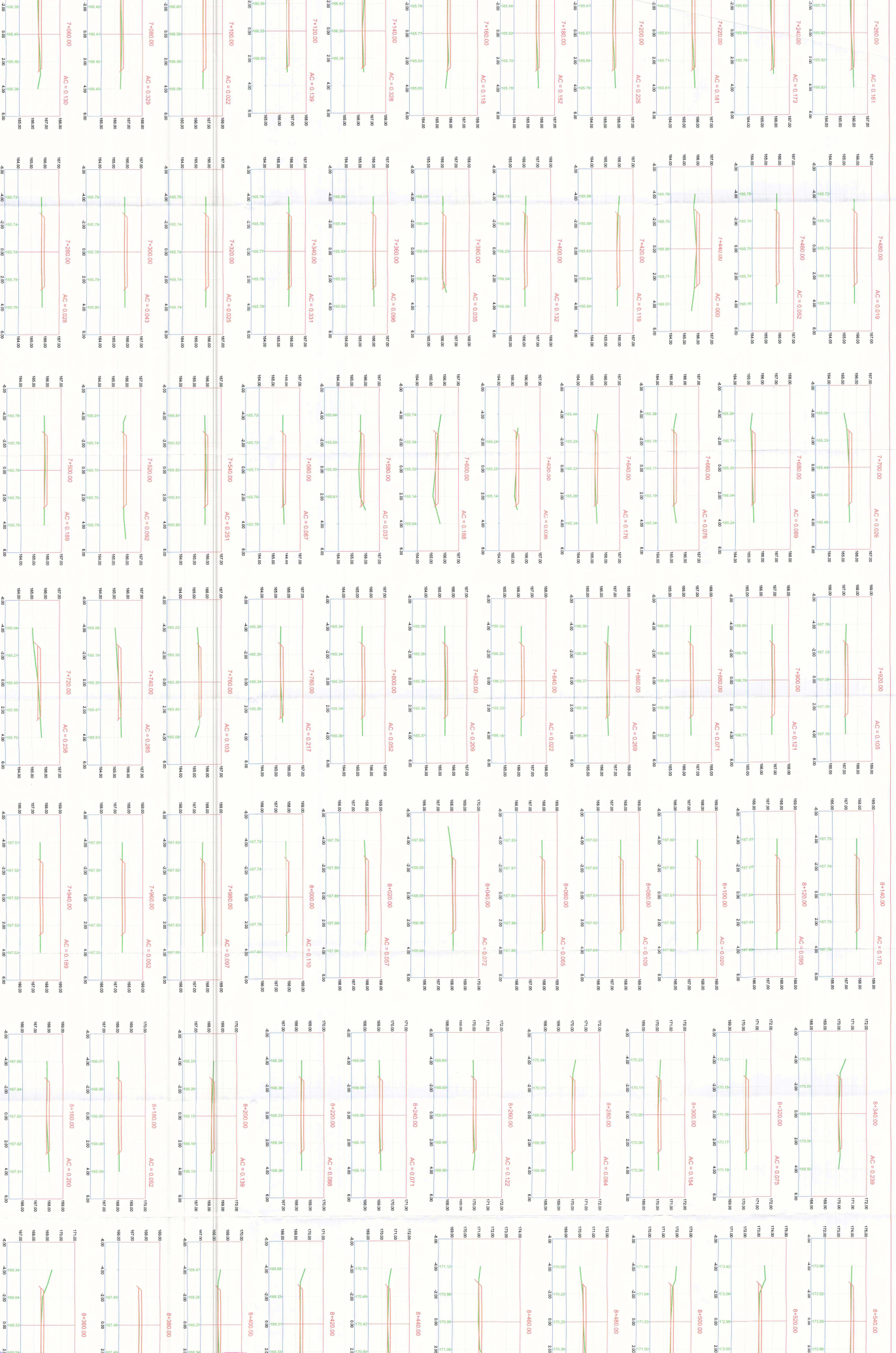
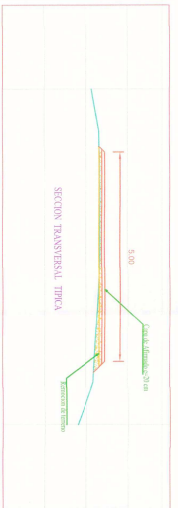

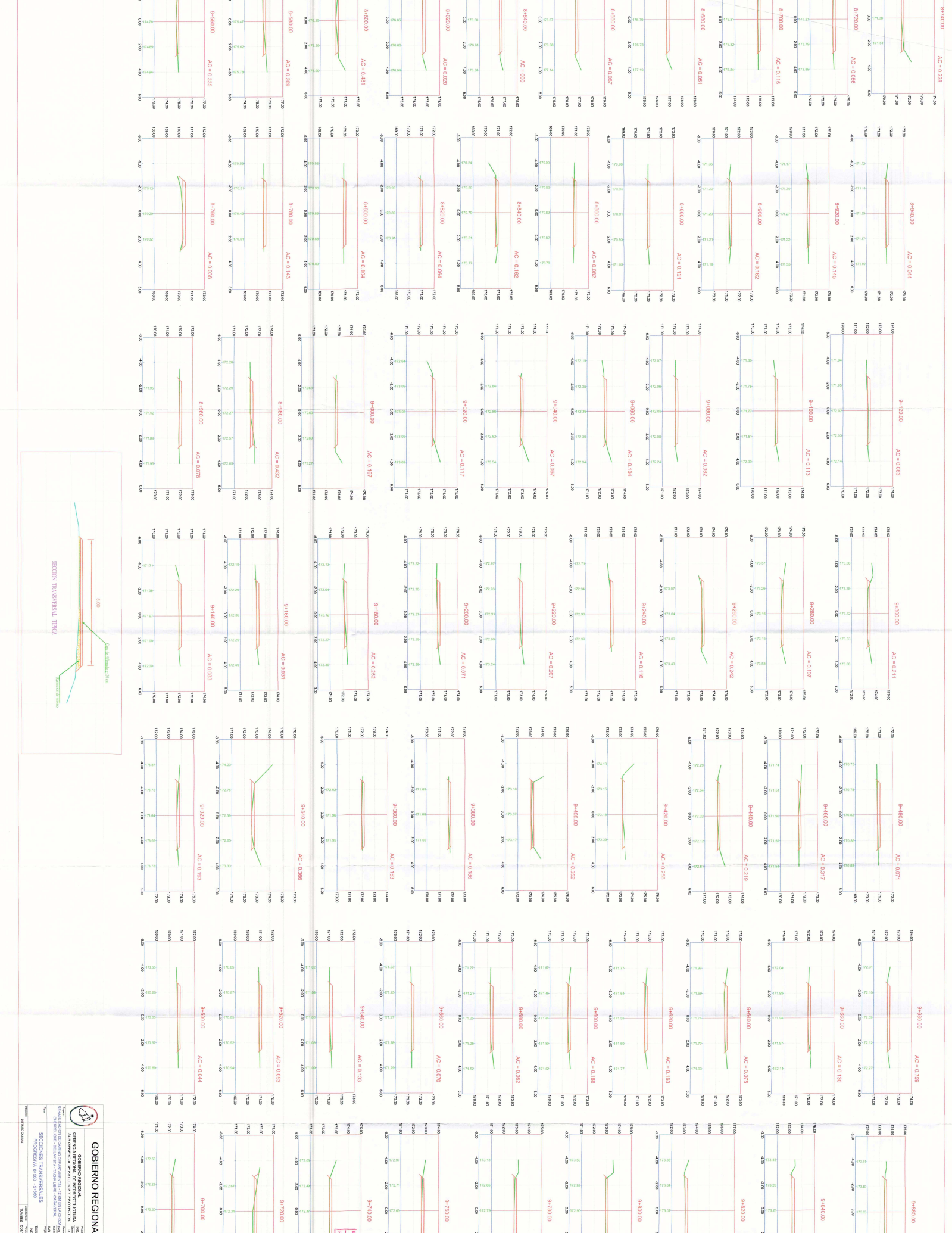

SECCION TRANSVERSAL TÍPICA

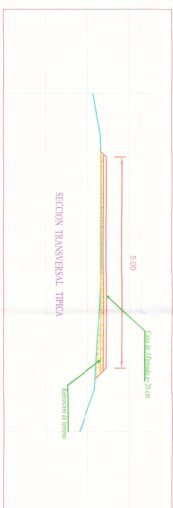

GOBIERNO REGIONAL DE PASCO
GOBIERNO REGIONAL DE PASCO
DIRECCIÓN REGIONAL DE INGENIERÍA DE TRANSPORTES Y VIALIDAD
UNIDAD ADMINISTRATIVA DE INGENIERÍA DE VIALIDAD
CAMBIEROS - BELLA VISTA - TROMA - CASHAPALTA
PROYECTO: RECONSTRUCCIÓN DE LA CARRETERA REGIONAL PASCO - TROMA - CASHAPALTA
PROYECTO: RECONSTRUCCIÓN DE LA CARRETERA REGIONAL PASCO - TROMA - CASHAPALTA

PROYECTO	RECONSTRUCCIÓN DE LA CARRETERA REGIONAL PASCO - TROMA - CASHAPALTA
FECHA	2023
ESCALA	1:100
PROYECTISTA	ING. JUAN CARLOS VILLALBA
REVISOR	ING. JUAN CARLOS VILLALBA
APROBADO	ING. JUAN CARLOS VILLALBA

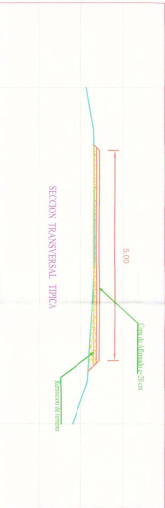
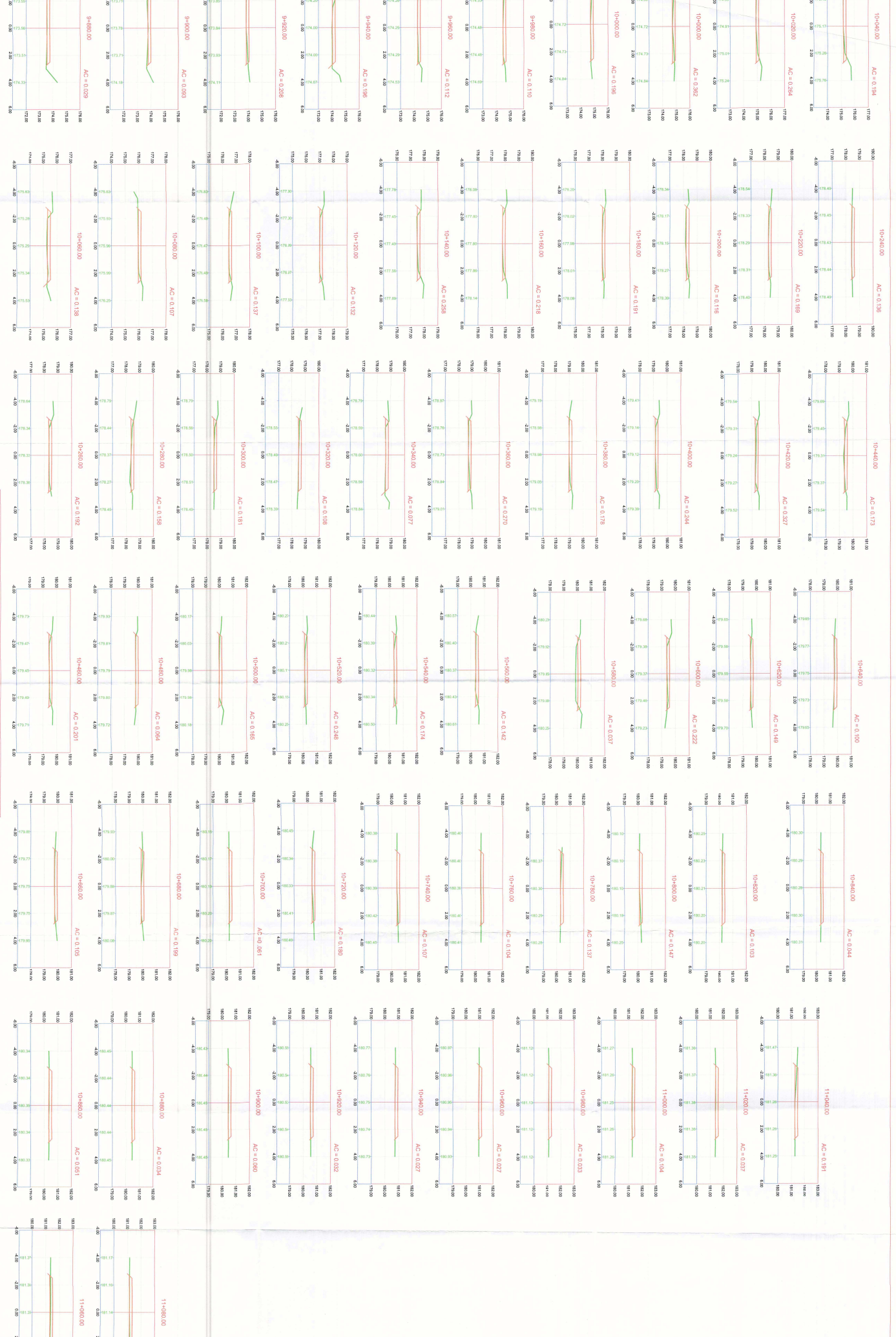

GOBIERNO REGIONAL DE PASAJE DE LA SIERRA
 DIRECCIÓN REGIONAL DE OBRAS PÚBLICAS
 INSTITUCIÓN DE OBRAS PÚBLICAS DEL DEPARTAMENTO DE PASAJE DE LA SIERRA
 SUBDIRECCIÓN DE OBRAS PÚBLICAS
 OFICINA DE INGENIERÍA DE OBRAS PÚBLICAS
 PROYECTO: RECONSTRUCCIÓN DEL PASEO DE LA SIERRA
 PROYECTO 9489 - 11-298

ESCALA: 1:500

PROYECTO 9489 - 11-298

INDICACIONES:
 1. REVISAR PLANOS ANTERIORES
 2. VERIFICAR DATOS DEL TERRENO
 3. VERIFICAR DATOS DEL DISEÑO

FECHA: 01/08/2019

PROYECTADO: J. GONZALEZ

REVISADO: J. GONZALEZ

APROBADO: J. GONZALEZ

PROYECTO 9489 - 11-298

INDICACIONES:
 1. REVISAR PLANOS ANTERIORES
 2. VERIFICAR DATOS DEL TERRENO
 3. VERIFICAR DATOS DEL DISEÑO

FECHA: 01/08/2019

PROYECTADO: J. GONZALEZ

REVISADO: J. GONZALEZ

APROBADO: J. GONZALEZ

PROYECTO 9489 - 11-298

INDICACIONES:
 1. REVISAR PLANOS ANTERIORES
 2. VERIFICAR DATOS DEL TERRENO
 3. VERIFICAR DATOS DEL DISEÑO

FECHA: 01/08/2019

PROYECTADO: J. GONZALEZ

REVISADO: J. GONZALEZ

APROBADO: J. GONZALEZ

PROYECTO 9489 - 11-298

INDICACIONES:
 1. REVISAR PLANOS ANTERIORES
 2. VERIFICAR DATOS DEL TERRENO
 3. VERIFICAR DATOS DEL DISEÑO

FECHA: 01/08/2019

PROYECTADO: J. GONZALEZ

REVISADO: J. GONZALEZ

APROBADO: J. GONZALEZ

PROYECTO 9489 - 11-298

INDICACIONES:
 1. REVISAR PLANOS ANTERIORES
 2. VERIFICAR DATOS DEL TERRENO
 3. VERIFICAR DATOS DEL DISEÑO

FECHA: 01/08/2019

PROYECTADO: J. GONZALEZ